



-DRAFT- Notice of Construction Activities

Notice Date: February 20, 2013
Projects: Butrovich Building Sidewalk Replacement (BUSI)
Butrovich Building Retaining Wall Repair (BUWR)
Project #'s: 2013018 BUSI
2011044 BUWR

BUSI Project Description-

- A. The existing sidewalk has undergone ice-jacking and differential shifting, creating an uneven surface. New sidewalk to be installed to reduce potential trip hazard.
- B. Project will bring sidewalk and parking lot up to current ADA accessibility standards.
- C. New sidewalk and parking lot to include improved drainage
- D. New, impact resistant lighted bollards will be installed.

BUWR Project Description-

- A. The existing east retaining wall has experienced significant vertical and horizontal movement.
- B. Project will construct a new retaining wall with partial demolition of existing retaining wall and substantial backfill work.
- C. Project will protect critical infrastructure such as the building transformers and parking lot.

Description of BUSI Project Activities-

- 1. Remove existing asphalt surface, curbs, sidewalk, and associated appurtenances in Butrovich's north parking lot. The two existing concrete planters will remain.
- 2. Install new asphalt surfaces, concrete curbs, sidewalk, and associated appurtenances in Butrovich's north parking lot.
- 3. The existing canopy will undergo work on its gutter and drainage system.

Description of BUWR Project Activities-

- 1. Remove soil adjacent to east retaining wall.
- 2. Construction of new retaining wall and drainage pathways.
- 3. Expand the K3 vault adjacent to the new wall.

Start Date of On-Site Work: June 10th, 2013

(North side work to be complete by August 20, 2013, reference associated construction map)

Complete Date of On-Site Work: September 10, 2013

For more specific project information, please contact Facilities Services, Division of Design and Construction at 474-5299.

-CONSTRUCTION NOTICE-

2013 BUTROVICH EXTERIOR CIVIL PROJECTS

CONSTRUCTION ACTIVITIES

Butrovich's west driveway, north parking lot and a portion of the southeast lot and adjoining sidewalk will be closed to public access due to construction of new sidewalk, parking lot and retaining wall work.

DRAFT

PARKING

June 10th, 2013	* Parking and access for Butrovich users will be affected.
to	* The East entrance will have a temporary stop location for shuttle call-ins.
September 10th, 2013	* User parking will be restricted to the locations outlined below.

VEHICLE TRAFFIC

June 10th, 2013	* East access road will remain open.
to	* Temporary Traffic signs will be posted.
September 10th, 2013	* Please exercise caution when traveling near the construction site.
	* Barriers will be erected around the construction site.
	* Deliveries to both loading docks to remain unrestricted.

BUILDING ACCESS

June 10th, 2013	* During construction the north entrances will be for emergency exit only. Normal access will be restored during phase 2 of Butrovich Sidewalk Replacement Project.
to	
September 10th, 2013	* Users are to access the building through the east access doors during phase 1 of the Butrovich Sidewalk Replacement Project.
	* Emergency vehicle access to be maintained, do not obstruct fire lane.

Butrovich Construction Map

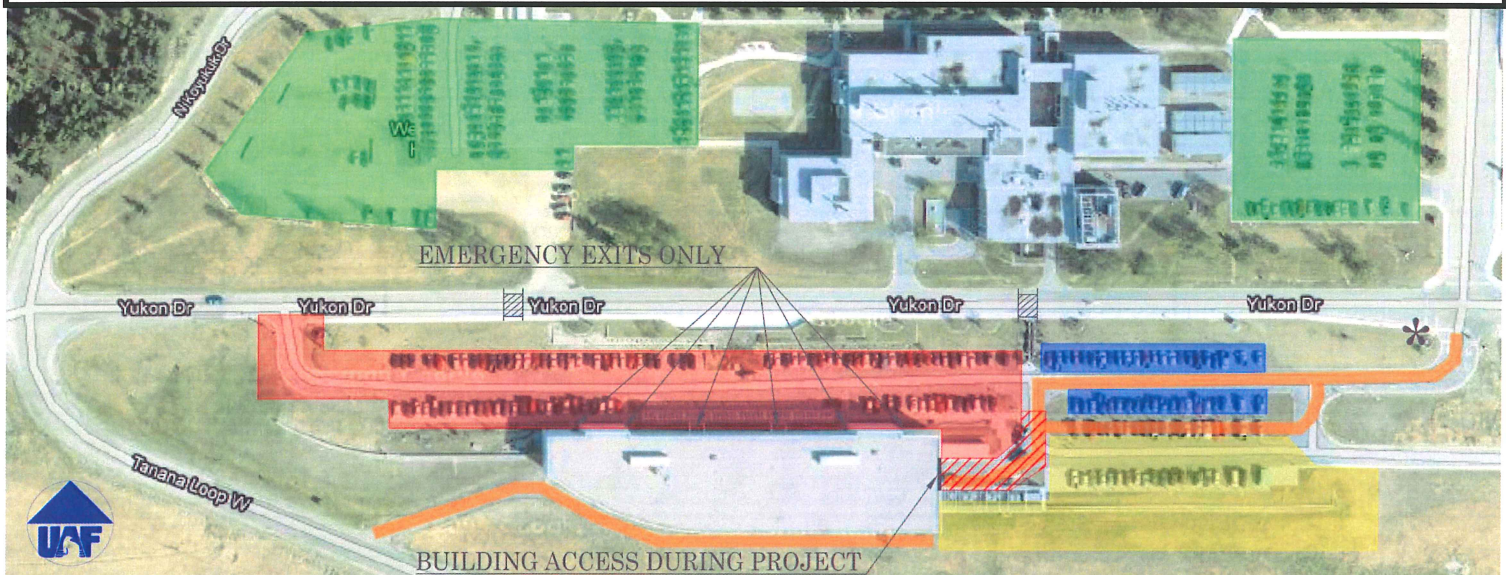

- BUTROVICH SIDEWALK REPLACEMENT PROJECT (BUSI) STAGING AND CONSTRUCTION ZONE, PHASE 1 (JUNE 10TH - AUG. 20TH)
- BUTROVICH SIDEWALK REPLACEMENT PROJECT (BUSI) STAGING AND CONSTRUCTION ZONE, PHASE 2 (AUG. 20TH - SEPT. 10TH)
- BUTROVICH RETAINING WALL REPAIR PROJECT (BUWR) STAGING AND CONSTRUCTION ZONE (JUNE 10TH - SEPT. 10TH)
- BUTROVICH USER PARKING LOCATIONS
- ADA PARKING & RESTRICTED PARKING - TEMPORARY RELOCATION
- FIRE LANE/DELIVERY TRUCK ACCESS (FED-EX, UAF DELIVERIES, OIT, POST OFFICE, ETC...) - DO NOT OBSTRUCT
- FOR UAF SHUTTLE SERVICE, CALL 474-RIDE (7433) FOR PICKUP AT THIS LOCATION
- TEMPORARY CROSSWALK LOCATIONS