



Construction In-Progress Reports

Capital Project Master Schedules:

1. UAA
2. UAF & UAS

UAA:

	<u>Procurement Method</u>
1. Alaska Airlines Center (Seawolf Sports Arena)	CMAR
2. Beatrice McDonald Building Renewal	DBB
3. 1901 Bragaw Tenant Improvements	DBB
4. Engineering and Industry Building	CMAR
5. Engineering Parking Garage	DBB
6. Existing Engineering Building Renewal	CMAR
7. Health Campus Pedestrian Bridge	CMAR
8. MAC Housing Renewal	CMAR
9. KPC Career and Technical Center	DBB
10. KPC Career and Technical Center --Paramedic and Nursing	DBB
11. KPC Career and Technical Center --Ward Offices	DBB
12. KPC Soil Remediation	DBB
13. KPC Student Housing	DBB
14. Mat-Su Valley Center for Arts & Learning	DBB

UAF:

1. Atkinson Power Plant Renewal	DBB
2. Critical Electrical Distribution Renewal Phase 2	CMAR
3. Engineering Facility	CMAR
4. Gruening Roof Replacement	DBB
5. Patty Center Bleacher Installation	DBB
6. Patty Ice Arena Ceiling and Rubber Floor Replacement	DBB
7. Road Improvements FMATS Street Light Conversion	State Project
8. Student Dining Development	P3
9. Taku Parking Lot Stairs	DBB
10. Utilities Main Waste System Line Repairs	DBB/CMAR
11. West Ridge Animal Quarters Facilities Relocation	CMAR
12. Kuskokwim Campus Deferred Maintenance	DBB
13. Toolik Field Station 2012 Capital Improvements	SS

UAS:

1. Auke Lake Way Corridor Improvements and Reconstruction	DBB
---	-----

- | | |
|--|-----|
| 2. Freshman Student Housing Phase 1 (Banfield Hall Addition) | DBB |
| 3. Juneau Campus Modifications 2014-2016 | DBB |
| 4. Technical Education Center Renewal | DBB |

Construction Procurement Method abbreviations:









Construction Manager at Risk	CMAR
Design - Bid - Build	DBB
Design – Build	DB
Not Applicable	N/A
Not yet Determined	N/D
Public Private Partnership	P3
Sole Source	SS

Construction in Progress Report abbreviations:

Construction Award Amount (Initial Award Amount)	CAA\$
Construction Contract Amount (Award Amount with additions for phases or changes)	CCA\$
Construction Manager at Risk	CMAR or CM@R
Deferred Maintenance and Renewal	DM&R
Formal Project Approval	FPA
Preliminary Administrative Approval	PAA
Project Change Request	PCR
Schematic Design Approval	SDA
Total Project Cost	TPC\$



Key to Symbols:

	Preliminary Administrative Approval		Phased Project Approval (# indicates Phase)		Construction Completion
	Formal Project Approval		Formal Project/Schematic Design Approval		Final Project Report
	Schematic Design Approval		Total Project Cost / Scope Change		

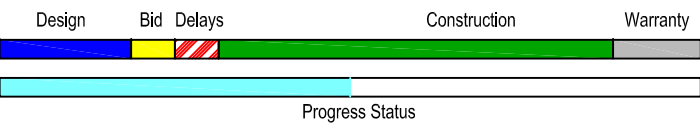

As of May 7, 2014

[illegible]



CAPITAL PROJECT MASTER SCHEDULE

Key to Symbols:

PA

F

S

P1

FS

T

C

R

Preliminary Administrative Approval

Formal Project Approval

Schematic Design Approval

Phased Project Approval (# Indicates Phase)

Formal Project/Schematic Design Approval

Total Project Cost / Scope Change

Construction Completion

Final Project Report

Design

Bid

Delays

Construction

Warranty

Progress Status

As of May 7, 2014

	FY09		FY10		FY11		FY12		FY13		FY14		FY15		FY16		FY17		FY18					
Project Approval Level	2008		2009		2010		2011		2012		2013		2014		2015		2016		2017		2018			
Main Campus > \$500,000 Community Campus > \$250,000	JAS Q1	OND Q2	JFM Q3	AMJ Q4	JAS Q1	OND Q2	JFM Q3	AMJ Q4	JAS Q1	OND Q2	JFM Q3	AMJ Q4	JAS Q1	OND Q2	JFM Q3	AMJ Q4	JAS Q1	OND Q2	JFM Q3	AMJ Q4	JAS Q1	OND Q2	JFM Q3	AMJ Q4
UAF PROJECTS	Atkinson Power Plant Renewal Phase 4 TPC \$40.4M Phase 4 \$1.6M																							
	Critical Electrical Distribution Renewal Phase 2 TPC \$26.3M																							
	Engineering Facility TPC \$108.6M																							
	Gruening Roof Replacement TPC \$990K																							
	Patty Center Bleacher Installation TPC \$675K																							
	Patty Ice Arena Ceiling and Rubber Floor Replacement TPC \$1.3M																							
	Road Improvements FMATS Street Light Conversion TPC \$2.0M																							
	P3 Student Dining Development TPC \$25.1M																							
	Taku Parking Lot Metal Stairs TPC \$500K																							
	Utilities Main Waste System Line Repairs FY14 TPC \$2.0M																							
	West Ridge Animal Quarters Facilities Relocation TPC \$8.3M																							
	Kuskokwim Campus Deferred Maintenance TPC \$1.2M																							
Toolik Field Station Construction TPC \$8.0M																								
UAS	Auke Lake Way Corridor Improvements TPC \$4.3M Phase 3 \$983K Phase 4 \$400K																							
	New Freshman Residence Hall TPC \$14.0M																							
	Juneau Campus Modifications 2014-2016 TPC \$12.8M Phase 1 \$5.0M																							
	Technical Education Center Renewal TPC \$4.6M Phase 1 \$1.5M																							

UAA SEAWOLF SPORTS ARENA



Project Description: 197,000 sf multi-use facility that will house a 5,000 seat performance gymnasium for basketball and volleyball; a practice and performance gym for the gymnastics program; support space consisting of a fitness and training room, administration/coaching offices, laundry, A/V production room, locker and team rooms for the basketball, volleyball, gymnastics, skiing, track, cross country and hockey programs; and a mezzanine area Restaurant.

BUDGET VS. ACTUAL

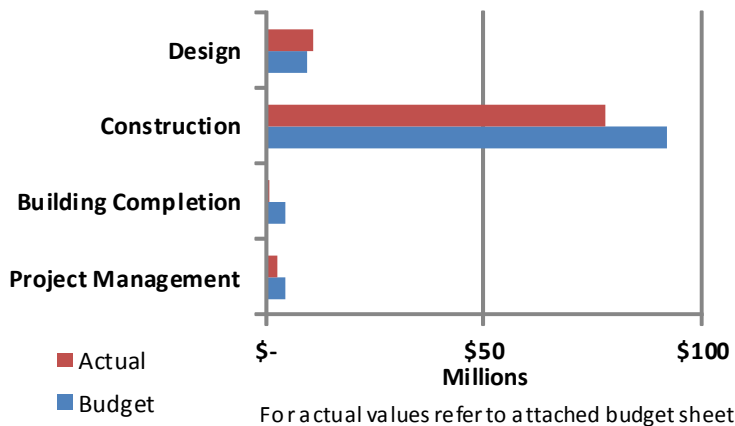

PROJECT INFORMATION

Designer: MCG, Hastings-Chivetta, AMC, R&M, BBFM

CM at Risk: Cornerstone General Contractor

Board Approvals:
 FPA: Feb '09/ June '11
 SDA: June '09/ Sept '11
 PCR: April 2014

Total Cost: \$110,585,000

Const. Cost: \$89,639,507

Occupancy: July, 2014

Funding: FY09/12 Capital /FY11GO Bond
FY14– NMS Contribution

SCHEDULE BAR CHART

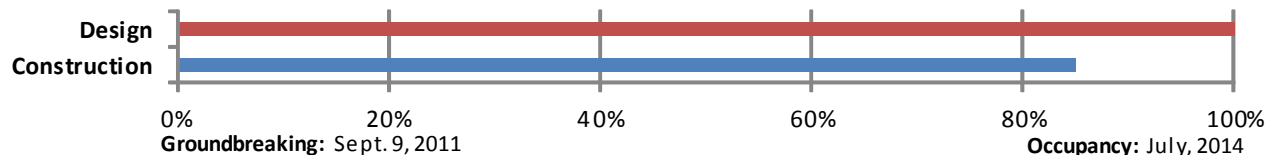

Status Update: Taping/painting, ceiling grid/tile, light fixtures, plumbing fixtures, column covers, and casework continue throughout the bldg.; 3 of the 4 elevators are tested and complete; wood flooring in the Performance & Auxilliary Gym are complete; installation of suite carpeting & vinyl continues; Installation of food service equipment continues in the Concession areas and basement food prep areas; installation of performance gym seating is complete. Hydro-worx therapy pool is tested and complete. Concourse & gym P-lam panel installation has begun.



UAA Seawolf Sports Arena

UNIVERSITY OF ALASKA		
Project Name: UAA Seawolf Sports Arena		
MAU: UAA		
Building: Alaska Airlines Center		Date: April 16, 2014
Campus: Anchorage		Prepared by: S.Vanover
Project #: 09-0006	Acct #(s): 512034 ; 564289 ; 564344 ; 590137 ; 515441	
Total GSF Affected by Project:	197,000	197,000
PROJECT BUDGET	Budget	Expenditure to Date
A. Professional Services		
Advance Planning, Program Development	\$3,126,000	\$3,126,000
Consultant: Design Services	\$5,000,000	\$5,411,717
Consultant: Construction Phase Services	\$750,000	\$1,401,359
Consul: Extra Services (Grphcs/Furn/Equip/Audit)		\$175,580
Site Survey	\$40,000	\$0
Soils/Concrete Testing & Engineering	\$45,000	\$64,797
Special Inspections	\$200,000	\$179,006
Plan Review Fees / Permits	\$250,000	\$513,101
Restaurant TI - Design/Constr. Admin	\$160,000	\$75,079
Professional Services Subtotal	\$9,571,000	\$10,946,639
B. Construction		
General Construction Contract(s)- Incl. Restaurant TI	\$84,080,000	\$70,295,429
Other Contractors (Site Clearing/Utilities Infrastructure)	\$435,000	\$269,874
Construction Contingency	\$7,329,000	\$7,143,904
Construction Subtotal	\$91,844,000	\$77,709,207
Construction Cost per GSF	\$466	\$394
C. Building Completion Activity		
Equipment	\$2,400,000	\$219,171
Fixtures	\$500,000	\$0
Furnishings	\$775,000	\$0
Signage not in construction contract		\$0
Move-Out Costs	\$0	\$0
Move-In Costs	\$70,000	\$0
Art	\$700,000	\$0
Other (Interim Space Needs or Temp Reloc. Costs)		\$545,576
OIT Support		\$222,027
Maintenance Operation Support	\$50,000	\$2,019
Building Completion Activity Subtotal	\$4,495,000	\$988,793
D. Owner Activities & Administrative Costs		
Project Plng, Staff Support		
Project Management	\$4,675,000	\$2,533,174
Misc. Expenses: Advertising, Printing, Supplies, Etc.		\$17,002
Owner Activities & Administrative Costs Subtotal	\$4,675,000	\$2,550,176
E. Total Project Cost	\$110,585,000	\$92,194,815
Total Project Cost per GSF	\$561	Remaining Budget
F. Total Appropriation(s)	\$110,585,000	\$18,390,185

UAA Beatrice McDonald Hall Renewal

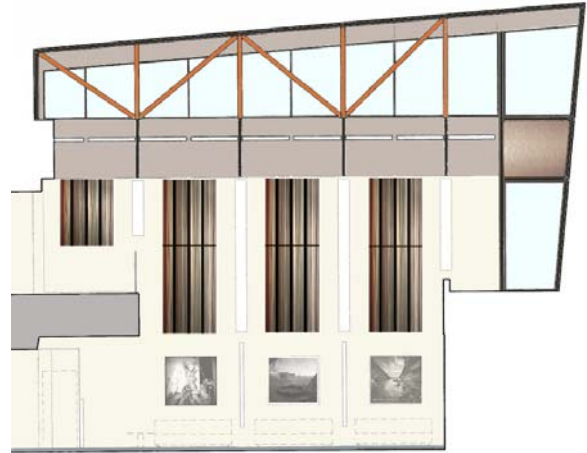

Project Description:

Complete renovation of 1970's building on main campus. Will include HAZMAT abatement, replacement of boiler, roof , mechanical systems, electrical systems, and architectural and exterior improvements.

BUDGET VS. ACTUAL

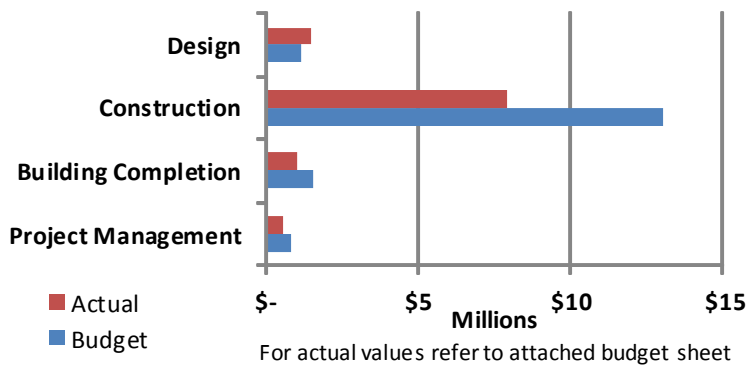

BASIC PROJECT INFORMATION

Designer: Architects Alaska

Contractor: Lake View General

Board Approvals:

FPA: 12/07/11

SDA: 08/17/12

Total Cost: \$16,508,213

Const. Cost: \$11,869,777

Occupancy: Spring Semester 2015

Funding: multi-year capital funding

SCHEDULE BAR CHART

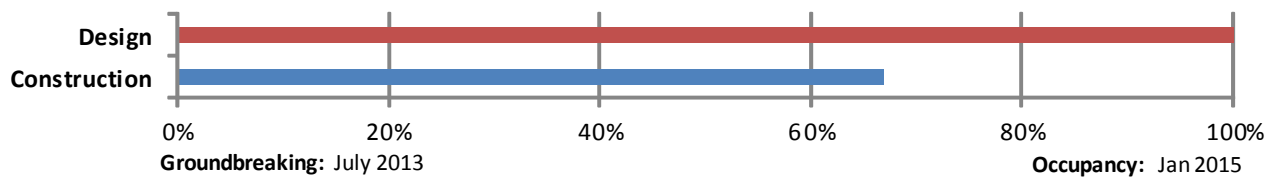

Status Update:

Interior walls , electrical and mechanical are in progress. Windows have been replaced. Landscaping Plan is being developed. Atrium roof construction began in April. Submittals are 62% complete.



UAA Beatrice McDonald Hall Renewal
Construction In Progress Budget Report

UNIVERSITY OF ALASKA		
Project Name: UAA Beatrice McDonald Hall Renewal		
MAU: Anchorage		
Building: AS 103	Date: 4/15/14	
Campus: Anchorage	Prepared by:	
Project #: 08-0042	Acct #(s): multi year capital funding	
Total GSF Affected by Project:	32,050	32,050
PROJECT BUDGET	Budget	Expenditure to Date
A. Professional Services		
Architects Alaska--full services	\$49,382	\$1,174,115
All phases and Ammendments.	\$141,769	
	\$282,460	
	\$350,285	
	\$217,562	
Survey, Materials testing		\$15,213
HazMat testing	\$100,000	\$100,000
Special Inspections		\$13,662
Bidding Permitting		\$10,000
Commissioning(PDC) Agent		\$48,827
Commissioning (AMC)Authority		\$84,800
		\$38,971
Professional Services Subtotal	\$1,141,458	\$1,485,588
B. Construction		
General Construction Contract(s)	\$11,869,777	\$7,900,000
Other Contractors (List:_____)		
Construction Contingency	\$1,186,978	
Construction Subtotal	\$13,056,755	\$7,900,000
Construction Cost per GSF	\$407	\$246
C. Building Completion Activity		
Equipment		
Fixtures		
Furnishings	\$900,000	\$757,000
Signage not in construction contract	\$20,000	\$3,000
Move-Out Costs	\$225,000	\$106,741
Move-In Costs	\$225,000	
Art	\$120,000	\$120,000
Other (Interim Space Needs or Temp Reloc. Costs)		
OIT Support	\$10,000	\$3,000
Maintenance Operation Support	\$10,000	\$3,000
Building Completion Activity Subtotal	\$1,510,000	\$992,741
D. Owner Activities & Administrative Costs		
Project Plng, Staff Support		
Project Management	\$800,000	\$550,000
Misc. Expenses: Advertising, Printing, Supplies, Etc.		
Owner Activities & Administrative Costs Subtotal	\$800,000	\$550,000
E. Total Project Cost	\$16,508,213	\$10,928,329
Total Project Cost per GSF	\$515	Remaining Budget
F. Total Appropriation(s)		\$5,579,884

UAA 1901 Bragaw Street Tenant Preparation



Project Description:

Plan, design and construct tenant improvements at the newly acquired 1901 Bragaw Street property necessary to accommodate the relocation of UAA occupants. Schedule and move UAA occupants from the UAA Diplomacy Building into the 1901 Bragaw Street facility prior to June 30th, 2015.

Schedule:

Planning & Design:	July 2013 – June 2014
Advertising & Award:	June 2014 – August 2014
Construction:	August 2014 – June 2015

Total Project Cost:

\$ 3,850,000

Board of Regents Approval & Motions:

Preliminary Administrative Approval	December 19, 2013
Formal Project Approval	February 20, 2014
Schematic Design Approval	April 4, 2014

Project Team:

Design Team:	Kumin & Associates
General Contractor:	TBD

Status Update:

Kumin & Associates has completed the Schematic Design, including tenant space allocation. Design Development is in progress.



UAA Engineering and Industry Building

New Building



Project Description: Planning, programming, design and construction of a 75,000 + gsf engineering laboratory and teaching areas not currently available on campus. The project includes: communications labs, electrical engineering labs, fluids labs, heat and mass transfer labs, soils mechanics labs, photogrammetry/cartography/GIS, seismic and earthquake labs, foundation engineering, transportation and highway engineering, land surveying, machine shop, wood shop, service yard and conferencing/ collaborative learning areas. The project will also include renovation of the existing building and structured parking for the facility and any displaced parking.

BUDGET VS. ACTUAL

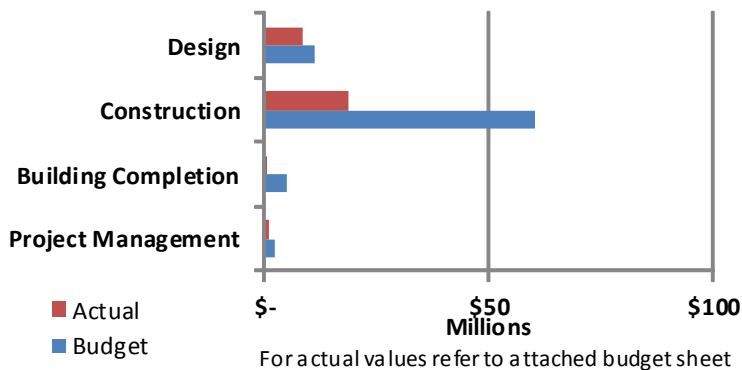

For actual values refer to attached budget sheet

SCHEDULE BAR CHART

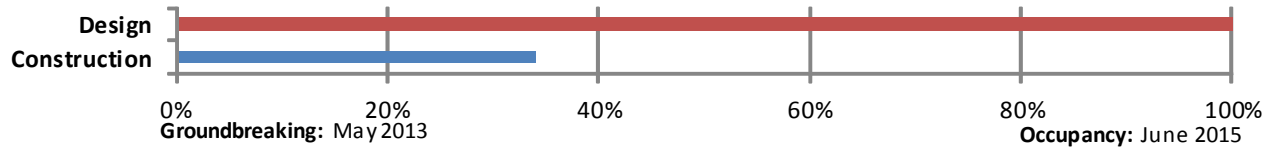

BASIC PROJECT INFORMATION:

Designer: Livingston Slone, Inc.
Ayer Saint Gross

CM@Risk: Neeser Construction

Board Approvals:

FPA September 2011

SDA June 2012 (Partial)
December 2012 (Full)

Total Project Cost: \$78,312,271

Construction Cost: \$60,244,011

Occupancy Date: June 2015

Status Update: Fabrication of structural steel for stairs complete; installation of stairs scheduled to start late April 2014. Rough-in of mechanical, plumbing, fire protection, electrical, telecommunications in progress on all four floors; installation of roof mounted mechanical equipment in progress; boilers and air handlers installed in 4th floor mechanical rooms; EPDM roof system on main roof completed; roof areas of stairwells to be completed when stair structural steel placed; exterior wall framing and wall assembly completed on all sides; installation of exterior metal siding started; framing of interior walls on all floors in progress; installation of doors on 3rd and 4th floors has started. Landscaping, sidewalks, and other site work to begin in spring 2014.



UAA Engineering Industry Building
New Building

UNIVERSITY OF ALASKA		
Project Name: UAA Engineering & Industry Building		
MAU: UAA		
Building: Engineering & Industry Building	Date:	4/26/2013
Campus: UAA Main Campus	Prepared by:	J. L. Hanson
Project #: 08-0024	Acct #(s):	
Total GSF Affected by Project:	81,500	
PROJECT BUDGET	Budget	Expenditure to Date
A. Professional Services		
Advance Planning, Program Development	\$412,750	\$412,750
Consultant: Design Services	\$7,500,000	\$7,106,334
Consultant: Construction Phase Services	\$1,968,500	\$786,440
Consul: Extra Services (List: _____)	\$201,000	
Site Survey		
Soils Testing & Engineering		
Special Inspections	\$219,075	\$85,334
Plan Review Fees / Permits	\$738,120	\$295,219
Other		
Professional Services Subtotal	\$11,039,445	\$8,686,077
B. Construction		
General Construction Contract(s)	\$54,767,283	\$18,740,935
Other Contractors (List: _____)		
Construction Contingency	\$5,476,728	\$0
Construction Subtotal	\$60,244,011	\$18,740,935
Construction Cost per GSF	\$739	
C. Building Completion Activity		
Equipment	\$1,158,875	
Fixtures		
Furnishings	\$1,174,750	\$89,142
Signage not in construction contract		
Move-Out Costs	\$158,750	
Move-In Costs	\$158,750	
Art	\$547,673	
Other (Interim Space Needs or Temp Reloc. Costs)	\$592,750	
OIT Support	\$825,500	
Maintenance Operation Support	\$190,500	\$93,078
Building Completion Activity Subtotal	\$4,807,548	\$182,220
D. Owner Activities & Administrative Costs		
Project Plng, Staff Support		
Project Management	\$2,204,605	\$835,399
Misc. Expenses: Advertising, Printing, Supplies, Etc.	\$16,662	\$8,162
Owner Activities & Administrative Costs Subtotal	\$2,221,267	\$843,561
E. Total Project Cost	\$78,312,271	\$28,452,793
Total Project Cost per GSF	\$961	Remaining Budget
F. Total Appropriation(s)	\$78,312,271	\$49,859,478

UAA Engineering and Industry Building

Parking Structure

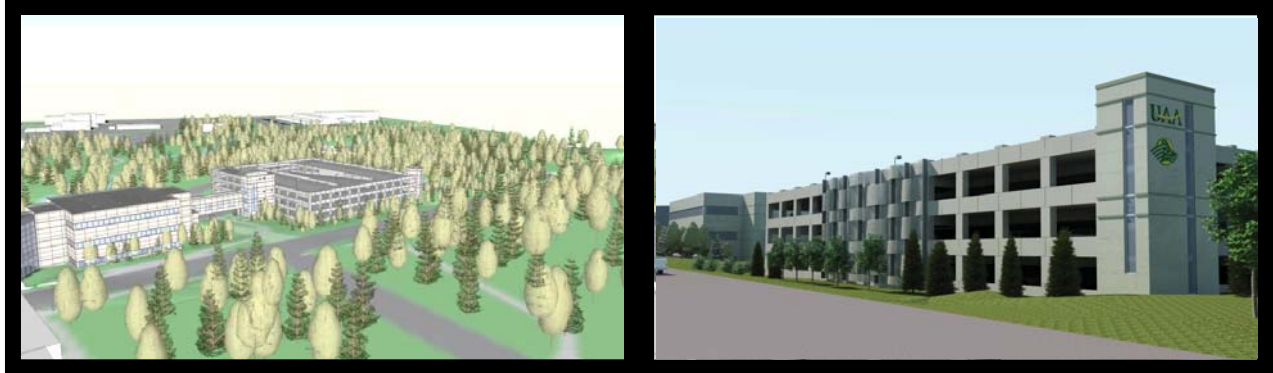

BUDGET VS. ACTUAL

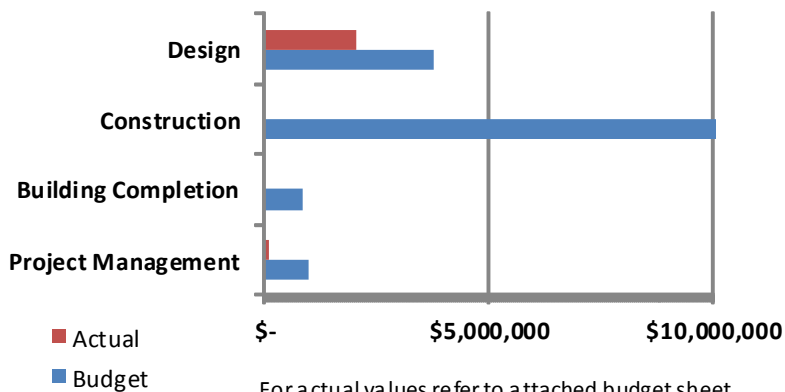

For actual values refer to attached budget sheet

BASIC PROJECT INFORMATION:

Designer: Livingston Slone, Inc.
Ayer Saint Gross

Design-Bid-Build: Contractor TBD

Board Approvals:
FPA September 2011
SDA June 2012 (Partial)
 December 2012 (Full)

Total Project Cost: \$28,331,274
Construction Cost: \$22,740,221

Occupancy Date: June 2015 (Tent.)

Funding Source: Multi-Year Capital Funding

SCHEDULE BAR CHART

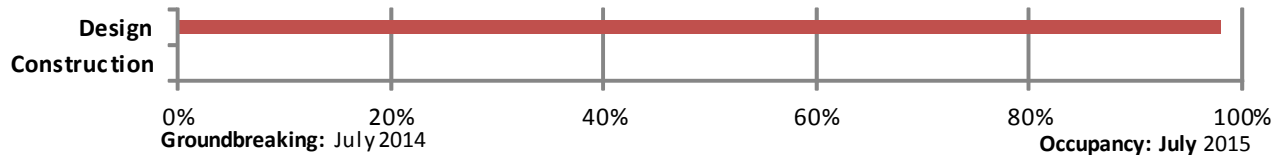

Status Update:

UAA is currently focusing construction activities on the new building. The parking structure is in Municipal Permit Review in preparation for advertising and awarding the construction contract upon receipt of required funding.



UAA ENGINEERING INDUSTRY BUILDING
Parking Structure

UNIVERSITY OF ALASKA		
Project Name: UAA Engineering & Industry Building		
MAU: UAA		
Building: Parking Structure	Date:	4/26/2013
Campus: UAA Main Campus	Prepared by:	J. L. Hanson
Project #: 08-0024	Acct #(s):	
Total GSF Affected by Project:	204,000	
PROJECT BUDGET	Budget	Expenditure to Date
A. Professional Services		
Advance Planning, Program Development	\$150,150	\$150,150
Consultant: Design Services	\$1,824,900	\$1,761,149
Consultant: Construction Phase Services	\$716,100	\$0
Consul: Extra Services (List: _____)		
Site Survey		
Soils Testing & Engineering		
Special Inspections	\$79,695	\$0
Plan Review Fees / Permits	\$996,072	\$115,733
Other		
Professional Services Subtotal	\$3,766,917	\$2,027,032
B. Construction		
General Construction Contract(s)	\$19,044,928	\$0
Other Contractors (Site Clearing, Temp. Bldg. Relocation)	\$728,000	
Mallard Lane Realignment	\$900,000	
Construction Contingency	\$2,067,292.80	\$0
Construction Subtotal	\$22,740,221	\$0
<i>Construction Cost per GSF</i>	<i>\$111</i>	
C. Building Completion Activity		
Equipment	\$50,000	\$0
Fixtures		
Furnishings	\$50,000	\$0
Signage not in construction contract		
Move-In Costs	\$100,000	\$0
Art	\$200,000	
Other (Interim Space Needs or Temp Reloc. Costs)		\$0
OIT Support	\$300,300	\$0
Maintenance Operation Support	\$161,675	\$0
Building Completion Activity Subtotal	\$861,975	\$0
D. Owner Activities & Administrative Costs		
Project Plng, Staff Support		
Project Management	\$996,100	\$80,000
Misc. Expenses: Advertising, Printing, Supplies, Etc.	\$6,061	\$913
Owner Activities & Administrative Costs Subtotal	\$1,002,161	\$80,913
E. Total Project Cost	\$28,371,274	\$2,107,945
<i>Total Project Cost per GSF</i>	<i>\$139</i>	Remaining Budget
F. Total Appropriation(s)	\$28,371,274	\$26,263,329

UAA Engineering and Industry Building

Existing Building Renewal



BUDGET VS. ACTUAL

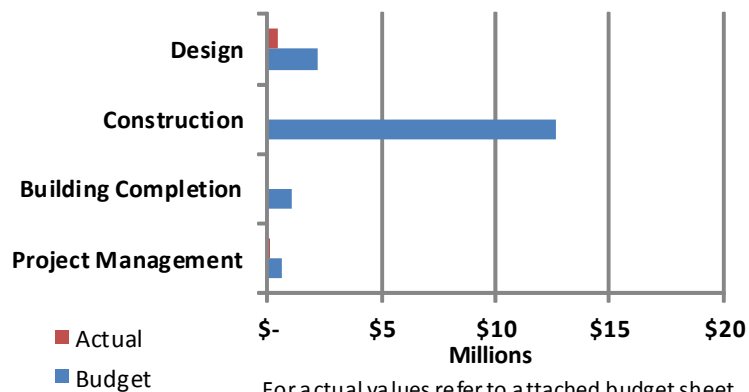

For actual values refer to attached budget sheet

BASIC PROJECT INFORMATION:

Designer: Livingston Slone, Inc.
Ayer Saint Gross

CM@Risk: Neeser Construction

Board Approvals:

FPA September 2011

SDA June 2012 (Partial)
December 2012 (Full)

Total Project Cost: \$16,556,455

Construction Cost: \$12,683,209

Occupancy Date: June 2016

Funding Source: Multi-Year Capital Funds

SCHEDULE BAR CHART

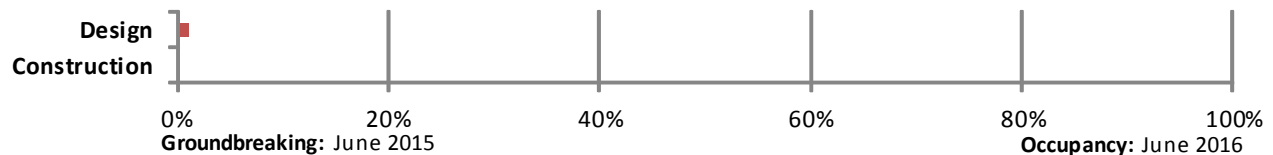

Status Update:

The consultant and CMAR contractor have conducted preliminary site visits for scope of work development. Concept development workshops are being held with the College of Engineering faculty. Design and construction are pending funding availability. Building renovation is anticipated to start in July 2015 with occupancy scheduled June 2016.



UNIVERSITY OF ALASKA		
Project Name: UAA Engineering & Industry Building		
MAU: UAA		
Building: Engineering Building (Existing), AS121	Date:	4/26/2013
Campus: UAA Main Campus	Prepared by:	J. L. Hanson
Project #: 08-0024		
Total GSF Affected by Project:	40,000	
PROJECT BUDGET	Budget	Expenditure to Date
A. Professional Services		
Advance Planning, Program Development	\$87,100	\$87,100
Consultant: Design Services	\$1,058,600	\$352,900
Consultant: Construction Phase Services	\$415,400	\$0
Consul: Extra Services (List: _____)		
Site Survey		
Soils Testing & Engineering		
Special Inspections	\$46,230	\$0
Plan Review Fees / Permits	\$577,808	\$0
Other		
Professional Services Subtotal	\$2,185,138	\$440,000
B. Construction		
General Construction Contract(s)	\$11,530,190	\$0
Other Contractors (List: _____)		
Construction Contingency	\$1,153,019	\$0
Construction Subtotal	\$12,683,209	\$0
<i>Construction Cost per GSF</i>	<i>\$317</i>	<i>\$1</i>
C. Building Completion Activity		
Equipment	\$244,550	\$0
Fixtures		
Furnishings	\$247,900	\$0
Signage not in construction contract		
Move-Out Costs	\$33,500	\$0
Move-In Costs	\$33,500	\$0
Art	\$115,327	\$0
Other (Interim Space Needs or Temp Reloc. Costs)	\$167,500	\$0
OIT Support	\$174,200	\$0
Maintenance Operation Support	\$40,200	\$0
Building Completion Activity Subtotal	\$1,056,677	\$0
D. Owner Activities & Administrative Costs		
Project Plng, Staff Support		
Project Management	\$627,915	\$1,000
Misc. Expenses: Advertising, Printing, Supplies, Etc.	\$3,516	\$0
Owner Activities & Administrative Costs Subtotal	\$631,431	\$1,000
E. Total Project Cost	\$16,556,455	\$441,000
<i>Total Project Cost per GSF</i>	<i>\$414</i>	Remaining Budget
F. Total Appropriation(s)	\$16,556,455	\$16,115,455

Health Campus Pedestrian Bridge



Project Description:

Planning, programming, design, and construction of a 3,000 gsf pedestrian bridge linking the Health Sciences Building and the new Engineering and Industry Building. The pedestrian bridge represents an opportunity to create a symbolic “gateway” to the University and provide a structure that reflects and celebrates the University as a driver for social, intellectual, and creative development. It will link the main campus and Health Sciences Campus enhancing academic collaboration and provide safe and secure circulation over Providence Drive.

Schedule:

Planning & Design:	Dec 2012 – Dec 2013
Advertising & Award:	Jan 2014 – May 2014
Construction:	June 2014 – June 2015

Total Project Cost:

TPC: \$ 6,121,730
CAA: \$ TBD

Project Team:

Design Team	Livingston Slone, Inc.
CM@Risk	Neeser Construction, Inc.

Board of Regents Approval & Motions:

Preliminary Admin Approval	February 2013
Formal Project Approval	April 2013
Schematic Design Approval	December 2013

Status Update:

Constructability review of design development documents in progress. 100% construction documents will be completed late April 2014. The Guaranteed Maximum Price (GMP) expected to be negotiated late May 2014. Footings and foundation work will be done during the summer of 2014. Steel erection scheduled for December 2014-January 2015 during the Christmas holiday break. The gallery will be started in December 2014 with completion of the pedestrian bridge scheduled for June 2015 to coincide with the completion of the Engineering and Industry Building.



UAA MAC Housing Renewal



Project Description:

The project scope includes the replacement of boilers and related mechanical and electrical equipment, upgrading the Fire Alarm Panel data lines to fiber, and the correction of additional life safety issues required to occupy the buildings while alternate housing approaches are evaluated.

Schedule:

Planning & Design:	Mar 2012 - Dec 2012
Construction	May 2013 – Sep 2014

Total Project Cost:

TPC	\$2,702,182
CAA	\$1,118,182

Project Team:

Design Team	Bezek Durst Seiser
CMAR Contractor	Watterson Construction

Board of Regents Approval & Motions:

Preliminary Admin Approval	October 2011
Formal Project Approval	June 2012
Schematic Design Approval	September 2012
Project Change Requests	April 2013

Status Update:

The work to replace boilers in MAC 1, provide a new boiler in MAC 6, upgrade DDC panels, and upgrade data lines to fiber, was completed in January, 2014. The project team has begun design for corrections to the 14 stairwells in the 6 buildings, and will implement the construction changes for all buildings in the summer of 2014.



KPC Career and Technical Center

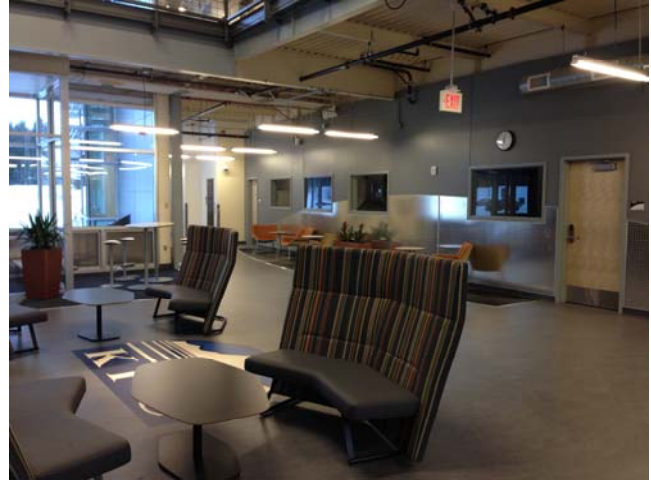

Project Description:

This building will be used for the Process Technology, Instrumentation and Electronics Programs. Three large labs for instrumentation, electronics and the simulation lab and a smaller fabrication lab are the main focus of the building. The building also contains three classrooms, a small conference room, eight offices for faculty, work area for an administrative assistant, workroom/break area, and student collaborative spaces. The entire building is 19,370 gsf.

BUDGET VS. ACTUAL

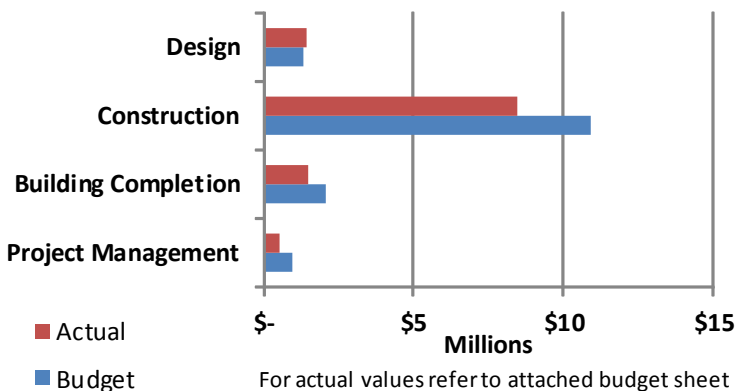

PROJECT INFORMATION

Designer: McCool Carlson Green

Contractor: Blazy Construction

Board Approvals:

FPA: 02/18/11

SDA: 09/23/11

PCA: 04/13/12, 12/12/13

Total Cost: \$15,250,000

Const. Cost: \$ 10,905,000 (Not Including renovation and reallocation)

Occupancy: Fall Semester 2013

SCHEDULE BAR CHART

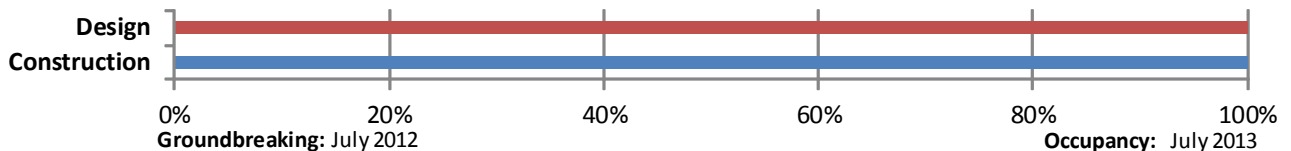

Status Update:

Building is complete as of August 7, 2013. Occupants are moved in and classes started August 27. The "Big Blue" process simulator is complete. The 1st phase of the backfill is complete as of April and the 2nd phase of the renovation and reallocation is out to bid. Although current construction cost status appears low, pending invoices, change orders, art work, and renovation and reallocation costs are still pending.



UAA KPC Career and Technical Education Center
Construction In Progress Budget Report

UNIVERSITY OF ALASKA			
Project Name: UAA KPC Career and Technical Education Center			
MAU: UAA			
Building: New	Date:	4/17/2014	
Campus: Kenai River Campus	Prepared by:	S. Sauve	
Project #: 10-0013	Acct #:	512030, 590084, 106210 FY11	
Total GSF Affected by Project:	New Building	19,370	19,370
	Backfill	9,533	9,533
PROJECT BUDGET		PCR #2	Expenditure to Date
A. Professional Services			
Advance Planning, Program Development			
Consultant: Design Services (Including Backfill)	\$ 1,180,500	\$	1,351,202
Consultant: Construction Phase Services			
Site Survey			
Soils Testing & Engineering			
Special Inspections	\$ 80,000	\$	52,954
Plan Review Fees / Permits	\$ 50,000	\$	35,098
Other			
Professional Services Subtotal		\$ 1,310,500	\$ 1,439,254
B. Construction			
General Construction Contract(s) 19,370 sf	\$ 8,082,500	\$	7,712,424
Replace existing Septic/Storm System	\$ -	\$	-
Backfill Phase 1 - Paramedic & Nursing	\$ 1,100,000	\$	737,269
Backfill Phase 2 - Ward Offices	\$ 1,800,000	\$	29,293
Construction Contingency	\$ 855,000	\$	-
Construction Subtotal		\$ 11,837,500	\$ 8,478,986
Construction Cost per GSF	New Building	524	524
C. Building Completion Activity			
Equipment	\$ 50,000	\$	53,007
Process Tech Equipment	\$ 1,100,000	\$	1,380,670
Furnishings	\$ 50,000	\$	40,267
Signage not in construction contract	\$ 12,500	\$	-
Move-In Costs			
Art	\$ 80,000	\$	3,500
Maintenance Operation Support			
Building Completion Activity Subtotal		\$ 1,292,500	\$ 1,477,444
D. Owner Activities & Administrative Costs			
Project Plng, Staff Support	\$ 290,000	\$	261,030
Project Management	\$ 519,500	\$	224,085
Misc. Expenses	\$ -	\$	37,580
Owner Activities & Administrative Costs Subtotal		\$ 809,500	\$ 522,695
E. Total Project Cost		\$ 15,250,000	\$ 11,918,379
Total Project Cost per GSF		\$ 717	Remaining Budget
F. Total Appropriation(s)		\$ 15,250,000	\$ 3,331,621

KPC Career & Technical Center Paramedic & Nursing



Project Description:

Backfill Phase 1 - moves Paramedic and Nursing from the Ward building to the rooms in the Goodrich Building vacated by the Process Technology program that has moved into the new Career & Technical Education Center. This backfill work was included in the SDA budget for the KPC Career & Technical Education Center project.

Schedule:

Planning & Design: July 2012-June 2013
Advertising & Award: July 2013
Construction: Sep 2013 - June 2014

Total Project Cost:

\$1,100,000

Board of Regents Approval & Motions:

Preliminary Admin Approval	Feb 2011 (KPC Career Tech Backfill)
Formal Project Approval	Feb 2011
Schematic Design Approval	Sep 2011
Project Change Requests	Feb 2012

Project Team:

Design Team: MCG, RSA
General Contractor: Orion Construction

Status Update:

Project was completed in April 2014 and punch list work is in progress.



KPC Career & Technical Center Backfill Phase 2 - Ward Offices



Project Description:

When the Backfill Phase 1 project is complete in May, then the Paramedic and Nursing programs will vacate space on the 2nd floor of the Ward building, allowing new offices to be built. The funding for this backfill project was included in the KPC Career & Technical Education Center project.

Schedule:

Planning & Design: November 2013-March 2014
Advertising & Award: March 2014
Construction: May 2014 - December 2014

Total Project Cost:

\$1,800,000

Board of Regents Approval & Motions:

Preliminary Admin Approval	Feb 2011 (KPC Career Tech Backfill)
Formal Project Approval	Feb 2011
Schematic Design Approval	Sep 2011
Project Change Requests	Feb 2012 & Dec 2013

Project Team:

Design Team: MCG, RSA
General Contractor: TBD

Status Update:

This Project is out to bid and construction will begin in May 2014.



KPC Soil Remediation



Project Description:

This project is cleaning-up an off-campus site that was used for fire training in the 1980's. The initial remediation efforts to till the soil to remove Diesel Range Organics have been successfully completed. Current efforts are focused on PFOS/PFOA contaminants in the ground water originating from fire-fighting foam.

Schedule:

Planning & Design:	Thru January 2010
Advertising & Award:	February 2010 – March 2010
Construction:	April 2010- October 2014

Total Project Cost:

TPC\$ 634,864
CCA\$ 286,747

Project Team:

Design Team	Shannon & Wilson
General Contractor	Foster Construction

Board of Regents Approval & Motions:

Preliminary Admin Approval	February 9, 2010
Formal Project Approval	February 17, 2010
Schematic Design Approval	February 17, 2010
Project Change Requests	6/1/10, 10/21/11, 1/10/11, 7/25/13, 1/31/14

Status Update: In May 2013 the DEC directed the site be tested for PFOS/PFOA, contaminants from firefighting foam. The tests from the excavation came back higher than the ADEC cleanup criterion. In February 2014, UAA installed additional monitoring wells near the edge of our property and sampled these monitoring wells as well as several of the adjacent neighbor's drinking wells that were willing to have their wells tested. The neighbor's drinking wells that were tested all came back with no detectable PFOS/PFOA. The new monitoring wells on our property exceeded the limit for PFOS and ADEC has directed further monitoring over the next two years. ADEC has also approved filling in the excavation and re-grading the site. A



Work Plan is being developed for DEC approval and work will proceed this summer.

KPC Student Housing



Project Description:

New student housing is a two story wood framed building with 24 suites for a total of 96 student beds. Four of the suites are ADA compliant. The suites have 4 bedrooms, two restrooms, small kitchen and living room. At the entrance there is a commons, multipurpose room, 2 offices, front desk, a kitchen and a maintenance area. On the second floor there is a study lounge, laundry room, and fitness room. The total sf is 39,875 sf.

BUDGET VS. ACTUAL

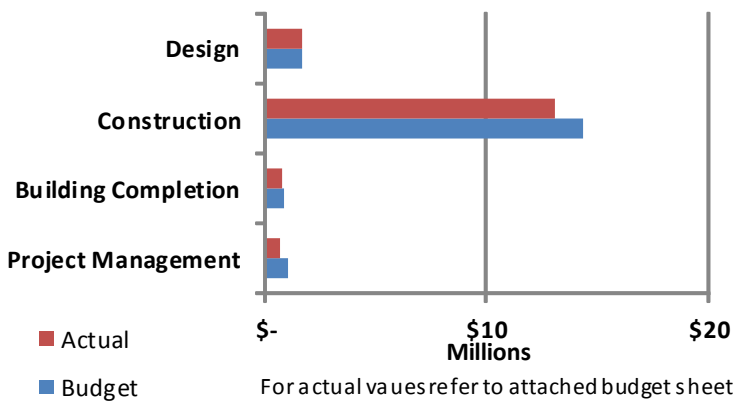

PROJECT INFORMATION

Designer: Bettisworth, RSA, BBFM, DOWL, HMS

Contractor: Bristol Environmental Remediation Services

Board Approvals:

FPA: 02/19/11

SDA: 09/23/11

Total Cost: \$17,800,000

Const. Cost: \$14,350,000

Occupancy: Fall Semester 2013

SCHEDULE BAR CHART

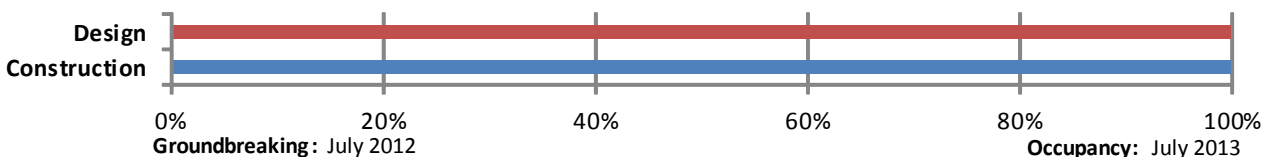

Status Update:

The project was sufficiently complete for students to move in on August 19 as scheduled. Although current construction cost status appears low, pending change orders, as well as program requirements that were previously value-engineered out of the project are still pending. For example, additional site improvements and drainage work could not be accomplished until this Spring.



UAA KPC Kenai River Campus Student Housing Complex
Construction In Progress Budget Report

UNIVERSITY OF ALASKA		
Project Name: KPC Kenai River Campus Student Housing Complex		
MAU: UAA		
Building: New	Date: 2/24/2014	
Campus: Kenai	Prepared by: S. Sauve	
Project #: 10-0066	Funding: 512031/564346	
Total GSF Affected by Project:	42,551	42,551
PROJECT BUDGET	SDA Budget	Expend to Date
A. Professional Services		
Advance Planning, Program Development	\$ 30,000	\$ -
Consultant: Design Services	\$ 1,280,000	\$ 1,497,055
Site Survey	\$ 15,000	\$ 7,100
Soils Testing & Engineering	\$ 40,000	\$ 92,629
Special Inspections	\$ 150,000	\$ 22,855
Plan Review Fees / Permits	\$ 130,000	\$ 39,069
Other /Interior Design	\$ -	\$ 26,350
Professional Services Subtotal	\$ 1,645,000	\$ 1,685,058
B. Construction		
General Construction Contract(s)	\$ 12,800,000	\$ 12,979,829
Utilities, Water, Power, Sewer	\$ 270,000	\$ 42,577
Clearing, South Central	\$ -	\$ 60,017
Construction Contingency	\$ 1,280,000	\$ -
Construction Subtotal	\$ 14,350,000	\$ 13,082,423
Construction Cost per GSF	337	307
C. Building Completion Activity		
Make Ready & Equipment - food prep area, phones	\$ 125,000	\$ 157,597
Furnishings	\$ 548,800	\$ 554,574
Art	\$ 128,000	\$ 7,000
Other (Interim Space Needs or Temp Reloc. Costs)		
Building Completion Activity Subtotal	\$ 801,800	\$ 719,171
D. Owner Activities & Administrative Costs		
Project Plng, Staff Support	\$ 417,200	\$ 372,450
Project Management	\$ 576,000	\$ 285,230
Misc. Expenses: Advertising, Printing, Supplies, Etc.	\$ 10,000	\$ 19,236
Project Contingency	\$ -	\$ -
Owner Activities & Administrative Costs Subtotal	\$ 1,003,200	\$ 676,916
E. Total Project Cost	\$ 17,800,000	\$ 16,163,568
Total Project Cost per GSF	\$ 418	Remaining Budget
F. Total Appropriation(s)	17,800,000	1,636,432

MSC Valley Center for Arts & Learning



Project Description:

The project will design and construct a new facility that will provide a classroom, drama lab, music space and instrument storage, display areas, gathering/study spaces and a 500 seat auditorium for lectures, public gatherings and conferences.

BUDGET VS. ACTUAL

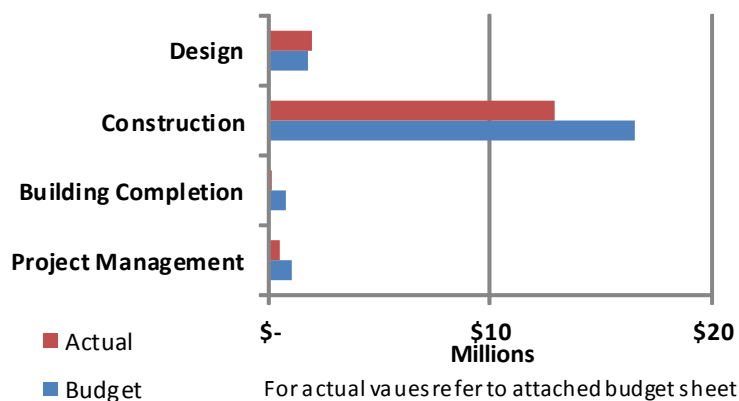

PROJECT INFORMATION

Designer: Kumin Associates Inc.
Contractor: Roger Hickel Contracting, Inc.

Board Approvals:

FPA: 11/02/11
 SDA: 06/08/12

Total Cost: \$20,000,000
Const. Cost: \$ 16,500,000
Occupancy: Spring Semester 2015
Funding: Capital Funding

SCHEDULE BAR CHART

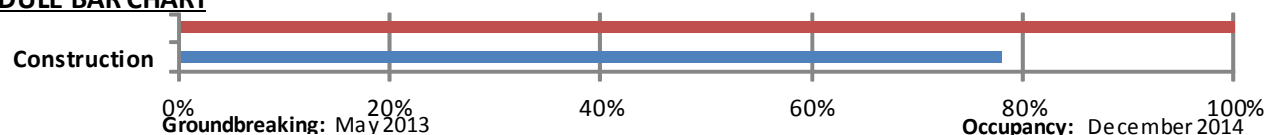

Status Update:

Building is enclosed, roofing is completed. The interior framing is almost complete; the back of house walls are being painted and being made ready for interior work. Electrical, HVAC, plumbing, audio-visual and fire protection work continues in the stage and commons areas. Exterior siding is scheduled to begin in May. Theater rigging is scheduled to begin in June. Civil work for curbs, sidewalks and paving is scheduled to resume in June for completion in August.



MSC Valley Center for Arts and Learning

UNIVERSITY OF ALASKA		
Project Name: MSC Valley Center for Arts & Learning		
MAU: UAA		
Building: New	Date:	May 2014
Campus: Mat-Su	Prepared by:	H Morse
Project #: 07-0035	Acct #:	512032
Total GSF Affected by Project:	30,000	30,000
PROJECT BUDGET	Budget	Expenditure to date
A. Professional Services		
Advance Planning, Program Development	\$200,000	\$200,000
Consultant: Design Services	\$1,200,000	\$1,382,723
Consultant: Construction Phase Services	\$300,000	\$215,159
Consul: Extra Services (Theater & A/V & Acoustical Consultants)	.	
Site Survey	\$8,500	\$8,634
Soils Testing & Engineering	\$30,000	\$30,000
Special Inspections	\$13,500	\$83,186
Plan Review Fees / Permits	\$8,000	\$17,160
Other		
Professional Services Subtotal	\$1,760,000	\$1,936,862
B. Construction		
General Construction Contract(s)	\$15,000,000	\$12,191,286
Other Contractors (List:_____)		\$0
Construction Contingency	\$1,500,000	\$727,852
Construction Subtotal	\$16,500,000	\$12,919,138
<i>Construction Cost per GSF</i>	<i>\$550</i>	<i>\$431</i>
C. Building Completion Activity		
Equipment	\$340,000	\$89,417
Fixtures		
Furnishings	\$200,000	\$0
Signage not in construction contract		
Move-Out Costs		
Move-In Costs		
Art	\$200,000	\$0
Other (Interim Space Needs or Temp Reloc. Costs)		
OIT Support		
Maintenance Operation Support		
Building Completion Activity Subtotal	\$740,000	\$89,417
D. Owner Activities & Administrative Costs		
Project Plng, Staff Support	\$400,000	\$121,704
Project Management	\$600,000	\$320,867
Misc. Expenses: Advertising, Printing, Supplies, Etc.		
Owner Activities & Administrative Costs Subtotal	\$1,000,000	\$442,571
E. Total Project Cost	\$20,000,000	\$15,387,988
<i>Total Project Cost per GSF</i>	<i>\$667</i>	Remaining Budget
F. Total Appropriation(s)	\$20,000,000	\$4,612,012

Atkinson Power Plant Renewal



Project Description:

The Atkinson Plant was built in 1964 and the equipment is nearing the end of its life. A list of items was developed to increase the life and reliability of the plant that supplies all of the heat and most of the electricity for the UAF campus. VFDs have been a source of boiler outages. Phase 3 replaces all of the critical variable frequency drives (VFD) in the Atkinson Plant. Phase 4A consists of replacing a failed boiler feed pump, installing a new air compressor and installing a new steam pressure reducing station for the Atkinson Plant. Phase 4B will install a new ash mixer and additional water treatment equipment to comply with new drinking water regulations.

Project Team:

Design Team: Design Alaska, Inc; Evergreen Engineering
General Contractor: Fulford Electric

Total Project Cost:

TPC \$40,400,000
(Phase 4 \$920,000)
CAA \$274,000
Equipment \$510,000

Board of Regents Approval & Motions:

Formal Project Approval: June 3, 2011
Schematic Design Approval (Ph1): August 12, 2011 (\$1,630,000)
Schematic Design Approval (Ph2): February 10, 2012 (\$1,927,500)
Schematic Design Approval (Ph3): February 10, 2013 (\$1,900,000)
Project Change Approval (Ph3): January 9, 2013 (1,100,000) decrease \$800,000
Schematic Design Approval (Ph4A): August 26, 2013 (\$920,000)
Schematic Design Approval (Ph4B): January 2014 (\$720,000)

Completion Date: Phase 3 - May 2014 Phase 4A - June 2014 Phase 4B - September 2014

Schedule Bar Chart:

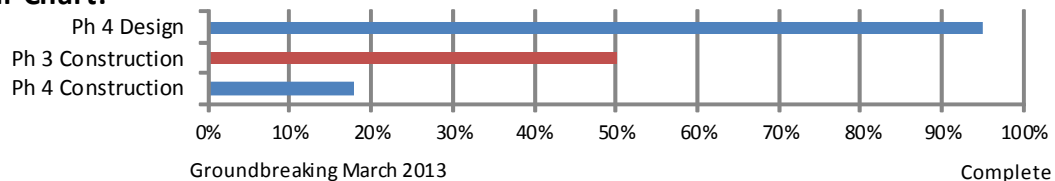

Status Update:

The design work for Phase 4 is nearly complete and the construction contract for the compressor work was bid in December 2013. The boiler feed pump and pressure reducing station work were bid in March 2014. Completion for



Phase 4A work is June 2014. Phase 4B went out to bid in February 2014 and work will be completed in September 2014. Phase 3 work is 50% complete and the remainder of the work is being completed in April/May 2014 during the annual boiler overhaul period.

Atkinson Power Plant Renewal

(All Phases)

UNIVERSITY OF ALASKA		
Project Name: Atkinson Power Plant Renewal		
MAU: UAF		
Building: 0	Date:	March 6, 2014
Campus: Fairbanks	Prepared By:	Mike Ruckhaus
Project #: 2010140 BARN	Account No.:	571297-50216
Total GSF Affected by Project:	N/A	
PROJECT BUDGET	Budget	Actual
A. Professional Services		
Advance Planning, Program Development	\$0	
Consultant: Design Services	\$3,000,000	\$455,000
Consultant: Construction Phase Services	\$400,000	\$140,000
Consult: Extra Services (List: _____)	\$40,000	
Site Survey	\$0	
Soils Testing & Engineering	\$0	
Special Inspections	\$50,000	
Plan Review Fees / Permits	\$0	
Other	\$0	
<i>Professional Services Subtotal</i>	\$3,490,000	\$595,000
B. Construction		
General Construction Contract (s)	\$30,700,000	\$4,828,274
Other Contractors (List: _____)	\$0	
Construction Contingency	\$2,609,500	\$400,000
<i>Construction Subtotal</i>	\$33,309,500	\$5,228,274
<i>Construction Cost per GSF</i>	N/A	
C. Building Completion Activity		
Equipment	\$0	\$920,000
Fixtures	\$0	
Furnishings	\$0	
Signage not in construction contract	\$0	
Move-Out Cost/Temp. Reloc. Costs	\$0	
Move-In Costs	\$0	
Art	\$0	
Other (List: _____)	\$0	
OIT Support	\$0	
Maintenance/Operation Support	\$0	
<i>Building Completion Activity Subtotal</i>	\$0	\$920,000
D. Owner Activities & Administrative Cost		
Project Planning and Staff Support	\$1,655,978	\$360,000
Project Management	\$1,839,975	\$240,000
Misc Expenses: Advertising, Printing, Supplies	\$80,000	\$5,000
<i>Owner Activities & Administrative Cost Subtotal</i>	\$3,575,953	\$605,000
E. Total Project Cost	\$40,375,453	\$7,348,274
<i>Total Project Cost per GSF</i>	N/A	Remaining Budget
		\$33,027,179



Critical Electrical Distribution Renewal Phase 2



Project Description:

Phase 1 of the project constructed a central switchgear facility and utilidors needed for distributing power to the campus at the new distribution voltage of 12,470v. Phase 2 converts the buildings on campus to the new distribution system. This includes replacement or conversion of cables, switches and building transformers throughout the UAF Fairbanks Campus.

Project Team:

Designer: PDC Inc. Engineers
CM@Risk : Kiewit Building Group

Total Project Cost:

TPC \$26,250,000
CAA \$ 9,945,000

Board of Regents Approval & Motions:

Formal Project Approval: February 16, 2012
Schematic Design Approval: June 8, 2012 (\$14,325,000)
Project Change Approval: September 27, 2013 (\$17,880,000)
Project Change Approval: April 9, 2014 (\$2,000,000)

Completion Date: Summer 2016

Schedule Bar Chart:

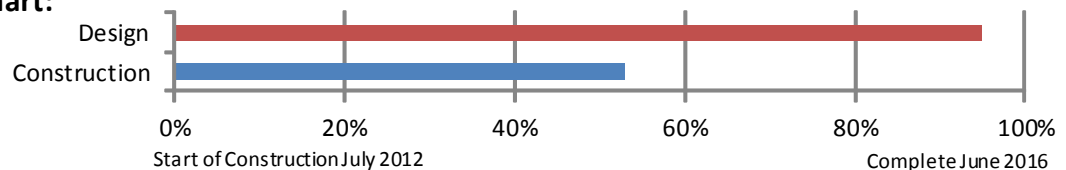

Status Update:

Construction in 2013 connected approximately 40% of the campus load to the new electrical distribution system. A minimal crew is continuing work on demolition and miscellaneous tasks. Priority transformers were connected to the new system in March for the Wood Center and the Library. Transformers and cable have been ordered for 2014 construction. Distribution cable is being installed before West Ridge buildings are connected to the new system.



Critical Electrical Distribution Renewal Phase 2

UNIVERSITY OF ALASKA

Project Name: Critical Electrical Distribution Renewal Phase 2

MAU: UAF

Building: N/A Date: May 7, 2014
 Campus: UAF Prepared By: M. Ruckhaus
 Project #: 2012108 UTER2 Account No.: 514449-50216

Total GSF Affected by Project: N/A

PROJECT BUDGET	SDA Budget	Actual
A. Professional Services		
Advance Planning, Program Development	0.0%	\$0
Consultant: Design Services	\$2,055,000	\$2,055,000
Consultant: Construction Phase Services	\$500,000	\$500,000
Consul: Extra Services (List: _____)	\$0	\$0
Site Survey	\$100,000	\$100,000
Soils Testing & Engineering	\$15,000	\$15,000
Special Inspections	\$0	\$0
Plan Review Fees / Permits	\$5,000	\$5,000
Other	\$0	\$0
<i>Professional Services Subtotal</i>	\$2,675,000	\$2,675,000
B. Construction		
General Construction Contract (s)	\$18,500,000	\$12,090,000
Other Contractors (List: GVEA)	\$1,000,000	
Construction Contingency	\$1,200,000	\$1,200,000
<i>Construction Subtotal</i>	\$20,700,000	\$13,290,000
<i>Construction Cost per GSF</i>	<i>N/A</i>	<i>N/A</i>
C. Building Completion Activity		
Equipment	\$1,500,000	\$1,500,000
Fixtures	\$0	\$0
Furnishings	\$0	\$0
Signage not in construction contract	\$0	\$0
Move-Out Cost/Temp. Reloc. Costs	\$0	\$0
Move-In Costs	\$0	\$0
Art	\$0	\$0
Other (List: _____)	\$0	\$0
OIT Support	\$0	\$0
Maintenance/Operation Support	\$150,000	\$150,000
<i>Building Completion Activity Subtotal</i>	\$150,000	\$1,650,000
D. Owner Activities & Administrative Cost		
Project Planning and Staff Support	\$1,058,625	\$1,058,625
Project Management	\$1,176,250	\$1,176,250
Misc Expenses: Advertising, Printing, Supplies	\$30,000	\$30,000
<i>Owner Activities & Administrative Cost Subtotal</i>	\$2,264,875	\$2,264,875
E. Total Project Cost	\$25,789,875	\$19,880,000
<i>Total Project Cost per GSF</i>	<i>N/A</i>	<i>Remaining Budget</i>
F. Total Appropriation(s)	\$26,250,000	\$6,370,000



UAF Engineering Facility



Project Description

The Engineering Facility project will be building 119,000gsf of new space and renovate about 30,000gsf of existing space in the Duckering Building in support of the UAF College of Engineering and Mines. The 6-story building will provide space for engineering learning and discovery and will feature open lab concepts and a high-bay area for practical application of engineering know how.

Designer: ECI Hyer, NBBJ, PDC Inc, AMC

CM@Risk: Davis Constructors

Board of Regents Approval & Motions:

Preliminary Project Approval	September 9, 2006
Formal Project Approval	June 4, 2010
Amended Formal Project Approval	September 23, 2011
Schematic Design Approval	June 8, 2012
Project Change Approval	September 27, 2013

Occupancy Date: TBD

Total Project Cost:

TPC \$108,600,000

CAA \$ 78,000,000

Funding Source:

State Capital Appropriation &
UA Revenue Bond

Schedule Bar Chart:

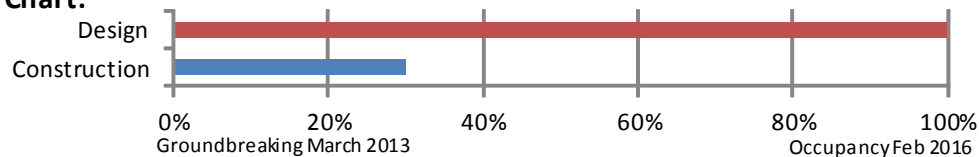

Status Update:

The steel erection is on-going with about 80% of the steel erected so far. The exterior wall panels are also being readied to mobilize on site as they are completed. Work in the basement rough-in electrical, plumbing, ventilation, and fire suppression is well underway. Full funding for the project was not received for FY15 and the completion date of the project is unknown.



UAF Engineering Facility

UNIVERSITY OF ALASKA					
Project Name: UAF Engineering Facility					
MAU: UAF					
Building: New		Date: May 2, 2014			
Campus: UAF		Prepared By: Wohlford			
Project #: 2011122 ENNF		Account No.: 50216-571304,571308,571339,571380			
Total GSF Affected by Project:		149000			
PROJECT BUDGET				PCR Budget	Actual
A. Professional Services					
Advance Planning, Program Development				\$737,198	\$737,198
Consultant: Design Services				\$7,504,556	\$7,504,556
Consultant: Construction Phase Services				\$2,167,091	\$1,093,294
CMAR Preconstruction Services				\$466,858	\$466,858
Misc Consulting and Peer Reviews				\$400,000	\$168,317
Soils Testing & Engineering				\$0	\$0
Special Inspections				\$25,000	\$0
Plan Review Fees / Permits				\$40,000	\$0
Other				\$0	\$0
Professional Services Subtotal Estimated				\$11,340,703	\$9,970,223
B. Construction					
General Construction Contract (s)				\$78,000,000	\$47,764,420
Other Contractors (List: Sewer, Duckering Renovations)				\$7,346,698	\$802,939
Construction Contingency				\$1,733,667	\$0
Construction Subtotal				\$87,080,365	\$48,567,359
Construction Cost per GSF				\$584.43	\$325.96
C. Building Completion Activity					
Equipment				\$450,000	\$0
Fixtures				\$150,000	\$0
Furnishings				\$850,000	\$0
Signage not in construction contract				\$37,500	\$0
Move-Out Cost/Temp. Reloc. Costs				\$185,000	\$0
Move-In Costs				\$350,000	\$0
Art				\$250,000	\$0
Other (List: Audio/Video)				\$700,000	\$0
OIT Support				\$500,000	\$3,191
Maintenance/Operation Support				\$350,000	\$89,302
Building Completion Activity Subtotal				\$3,822,500	\$92,493
D. Owner Activities & Administrative Cost					
Project Planning and Staff Support				\$3,564,737	\$1,000,975
Project Management				\$1,951,695	\$410,951
Misc Expenses: Advertising, Printing, Supplies				\$840,000	\$151,564
Owner Activities & Administrative Cost Subtotal				\$6,356,432	\$1,563,491
E. Total Project Cost				\$108,600,000	\$60,193,565
Total Project Cost per GSF				\$728.86	Remaining Budget \$48,406,435
F. Total Appropriation(s)				\$108,600,000	



Gruening Roof Replacement



Project Description:

This project will replace the 40-year old existing roof system on the Gruening Building, located on the UAF Campus in Fairbanks with a 20-year minimum warranty roof. The hand rails at the parapet perimeter will also be raised to meet current OSHA fall protection standards.

Schedule:

Planning & Design: September 2013 to March 2014
Advertising & Award: March to May 2014
Construction: May to July 2014

Total Project Cost:

TPC \$ 1.33 M
CAA \$ 499,600

Project Team:

Design Team: Bezek Durst Seiser/USKH
General Contractor: Rain Proof Roofing

Board of Regents Approval & Motions:

Preliminary Admin Approval: FY13 Capital Budget Project
Formal Project Approval: October 30, 2013
Schematic Design Approval: December 18, 2013

Status Update:

Schematic Design Approval was received in December 2013. On site construction started mid-May and is due to be completed by mid-July.



Patty Center Bleacher Installation

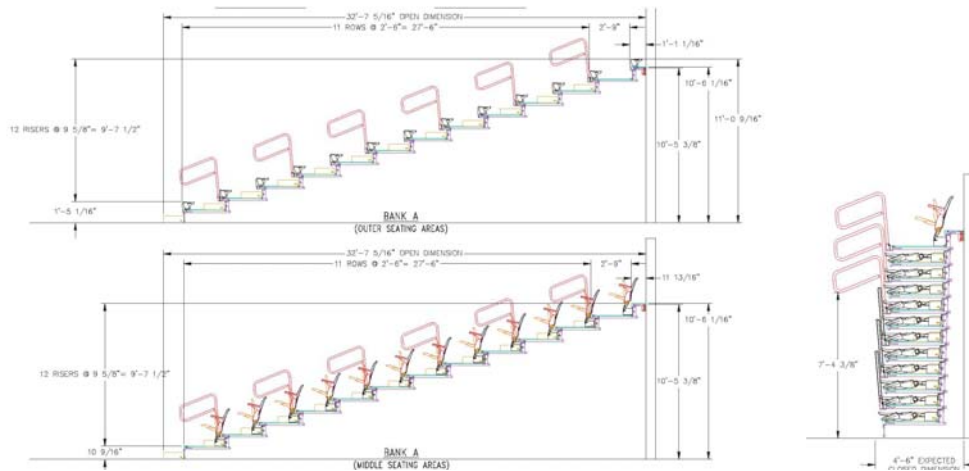

Project Description:

This project will replace the non-code compliant wooden bleachers in the Patty Gym with plastic stadium and bench seating. The project will demolish the existing bleachers, provide electrical upgrades for the new bleachers, refinish newly exposed areas of wood flooring due to the slightly different configuration of the new bleachers, and paint the gym walls.

Schedule:

Planning & Design: February 2014—March 2014
 Advertising & Award: March 2014—April 2014
 Construction: June 2014—September 2014

Total Project Cost:

TPC \$ 675,000
 CAA \$ TBD (To be awarded in June)

Project Team:

Design Team: UAF Design and Construction
 General Contractor: TBD

Board of Regents Approval & Motions:

Preliminary Admin Approval: March 18, 2014
 Formal Project Approval: March 20, 2014
 Schematic Design Approval: March 25, 2014

Status Update:

The bleachers have been purchased through the UAF Procurement Office. They are expected to arrive in Fairbanks in mid-July. The bleacher installation contractor will begin work in late June in order to complete all the prep-work for the bleacher installation.



NOTE: SEE SEE ALSO SEE ALSO - EXTENT OF BUILDING, INCLUDING ARENA, RINK, AND SURROUNDING AREAS, INCLUDING RESTROOMS, SERVICE AREAS, AND OTHER AREAS.

ICE ARENA

FLOODED RINK CENTER

PARTY COMPLEX

RESTROOMS

SERVICE AREAS

OTHER AREAS

ALTERNATE #1 SERVICE

ALTERNATE #2 SERVICE

This project will protect and preserve the Patty Ice Arena ceiling and structural components by removing rust and repainting it. It will remove flooring related tripping hazards by replacing and repairing flooring and it will increase the longevity and improve the usefulness of the locker rooms.

Planning & Design:	January 2013—March 2014
Advertising & Award:	March 2014—April 2014
Construction:	April 2014—August 2014

TPC \$ 1,347,000
CAA \$ TBD

Design Team: USKH
General Contractor: TBD

Preliminary Admin Approval:	December 19, 2013
Schematic Design Approval:	February 11, 2014

Design of this project is now complete. Construction has been delayed until 2015 to mitigate impacts to the skating community while the Fairbanks Borough completes much needed improvements to the Big Dipper Ice Arena.



Road Improvements

FMATS Street Light Conversion Stage III



Project Description:

The Alaska Department of Transportation and Public Facilities (DOT&PF) and the Alaska Division Office of the Federal Highway Administration (FHWA), in cooperation with UAF, will convert campus roadway illumination fixtures to light emitting diode (LED) or other appropriate technology under Stage III of the FMATS Streetlight Conversion Project. Funding will come from DOT&PF and FHWA with a small match from UAF.

Schedule:

Planning & Design:	July 2013 to March 2014
Advertising & Award:	March to June 2014
Construction:	July to October 2014

Total Project Cost:

TPC \$ 2,030,983 (\$220k from UAF)
CAA \$ TBD (To be awarded in June)

Project Team:

Architect / Engineer:	Design Alaska, Inc.
General Contractor:	TBD

Board of Regents Approval & Motions:

Preliminary Admin Approval:	October 8, 2012
Formal Project Approval:	September 26, 2013
Schematic Design Approval:	December 12, 2013

Status Update:

Design is now complete and Alaska DOT has advertised this project. Award is expected in late June 2014. The UAF Division of Design and Construction is working on a plan to include installation of an energy saving lighting control system as part of the construction phase of this project.



Campus Wide Student Dining Development



View out South Windows

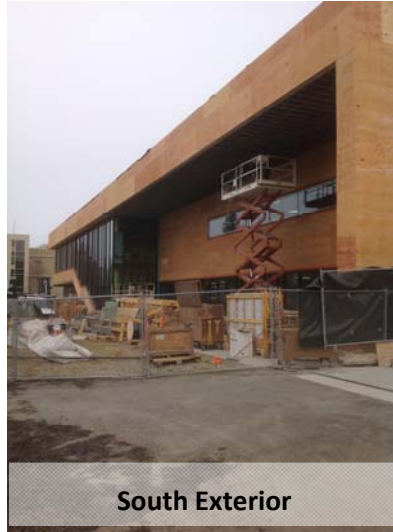

South Exterior

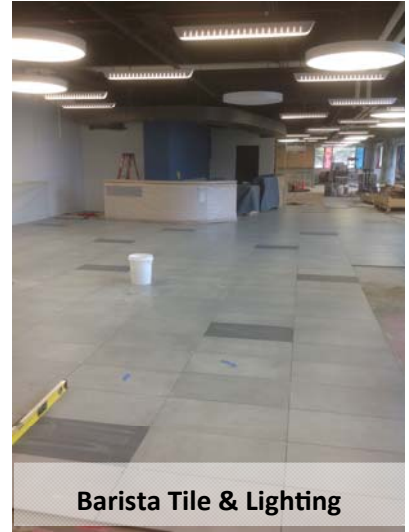

Barista Tile & Lighting

Project Description:

Design and build a new student dining facility adjacent to the Wood Center through a public-private partnership.

Schedule:

Planning & Design: March 22, 2011 to February 18, 2013
Advertising & Award: N/A
Construction: May 1, 2013 to July 16, 2014

Total Project Cost:

TPC \$ 25,070,000
CAA \$ 19,365,000

Project Team:

Design Team: Perkins & Will
General Contractor: GHEMM Company

Board of Regents Approval & Motions:

Preliminary Admin Approval: N/A
Formal Project Approval: June 2, 2011
Schematic Design Approval: September 28, 2012

Status Update:

The contractor is substantially complete with the first floor of the project. Commissioning has begun on the first floor. The substantial completion of the second floor will occur by the third week of June; followed by commissioning. Exterior work of the new roundabout between Wickersham Hall, Chapman and the Wood Center began mid-May. Final completion of the project is still anticipated to be in mid-July.

Taku Parking Lot Metal Stairs Design & Installation

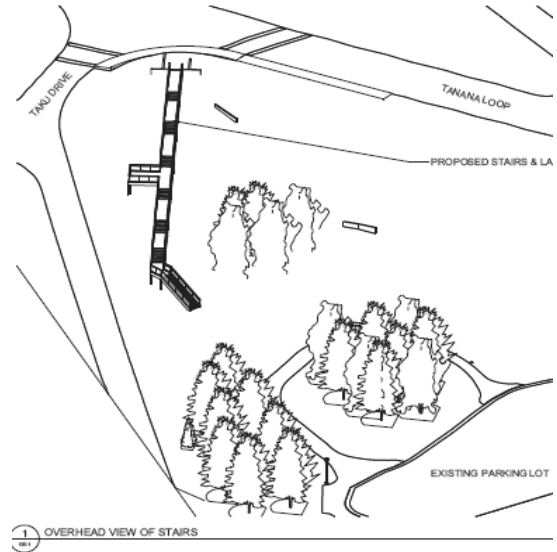

Project Description:

The proposed metal stairs will replace the existing steep sidewalk with safe, functional and low maintenance metal stairs. The stairs will significantly minimize the amount of slips and falls on the route to and from Taku and Ballaine Parking lots.

Schedule:

Planning & Design:	February to June 2013
Advertising & Award:	July to August 2013
Construction:	September 2013 to August 2014

Total Project Cost:

TPC \$ 500,000
CAA \$ 311,000

Project Team:

Design Team:	USKH, Inc
General Contractor:	Tatitlek Construction, Inc

Board of Regents Approval & Motions:

Preliminary Admin Approval:	May 30, 2013
Formal Project Approval:	July 16, 2013
Schematic Design Approval:	July 18, 2013

Status Update:

The construction contract has been awarded. Materials have been ordered and fabrication of the stairs has begun. Installation is being scheduled for Summer 2014.



Utilities Main Waste System Line Repairs



Duckering Building

Project Description:

This project will serve to continue the Fairbanks Campus Utilities Main Wasteline Repairs. Current projects under the Fairbanks Campus Utilities Main Wasteline Repairs include the Main Wasteline Replacement Wood Center to Hess Village phased construction, Wood Center Vault construction, Sewer Main Relining construction on West Ridge, storm drain rerouting at various buildings and design work at strategic locations for continued system operations.

Schedule:

Planning & Design:	2013 to March 2014
Advertising & Award:	March 2014 to June 2014
Construction:	2014-2015 Season

Total Project Cost:

TPC \$ 1,200,000
CAA \$ 904,750

Project Team:

Design Team:	PDC Inc. Engineers
General Contractor:	R & D Environmental and Construction Unlimited

Board of Regents Approval & Motions:

Preliminary Admin Approval:	FY 14 Capital Project
Formal Project Approval:	February 2014
Schematic Design Approval:	March 2014
Project Change Requests:	None

Status Update:

Contracts have been awarded on the main wasteline replacement from Wood Center to Hess Village CH13 Phase I and sewer main relining construction on West Ridge.



West Ridge Animal Quarters Facilities Relocation



Project Description

The West Ridge Animal Facility Relocation project will complete shelled space in the UAF Biological Research and Diagnostics Facility (BiRD) and the UAF portion of the State Virology Lab. The completed space will be constructed to house the animal care facility currently in Irving 1. The current animal housing in Irving 1 has surpassed its useful life by many years, has a large maintenance backlog, and struggles to maintain compliance with codes and regulations related to employee safety and animal care.

Designer: Bettisworth North Architects and Planners Inc.

CM@Risk: TBD

Board of Regents Approval & Motions:

Preliminary Project Approval	June 2012
Formal Project Approval	December 2012
Schematic Design Approval	September 27, 2013

Occupancy Date: February 2015

Total Project Cost:

TPC \$8,700,000

CAA \$ 6,500,000

Schedule Bar Chart:

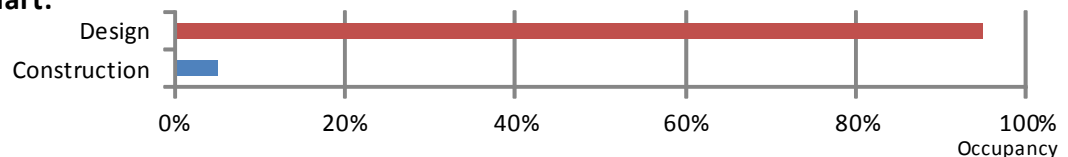

Status Update:

The first Work Package is under contract for long lead equipment, sheet metal, and the hibernation chambers. Construction documents for the project are due in early June. The Construction Manager at Risk has solicited bids for plumbing and electrical and a final GMP for the second work package will be in place by Mid-June. A PCR was processed to add \$400,000 to cover the cost of a new standby generator for the State of Alaska's Public Health Facility and a new animal holding cage washer.



West Ridge Animal Quarters Facilities Relocation

UNIVERSITY OF ALASKA			
Project Name: West Ridge Animal Resources Facility Relocation			
MAU: UAF			
Building:	BiRD/Virology	Date:	May 2, 2014
Campus:	Fairbanks	Prepared By:	Wohlford
Project #:	WRARF 2013174	Account No.:	571345/571371-50216
Total GSF Affected by Project:		8000	
PROJECT BUDGET		SDA Budget	Actual
A. Professional Services			
Advance Planning, Program Development		\$0	\$0
Consultant: Design Services		\$675,000	\$635,905
Consultant: Construction Phase Services		\$75,000	\$0
Consul: Extra Services (List: _____)		\$63,500	\$62,655
Site Survey		\$0	\$0
Soils Testing & Engineering		\$0	\$0
Special Inspections		\$15,000	\$0
Plan Review Fees / Permits		\$15,000	\$0
Other		\$0	\$0
<i>Professional Services Subtotal</i>		\$843,500	\$698,560
B. Construction			
General Construction Contract (s)		\$6,500,000	\$0
Other Contractors (List: _____)		\$0	\$0
Construction Contingency		\$407,000	\$0
<i>Construction Subtotal</i>		\$6,907,000	\$0
<i>Construction Cost per GSF</i>		\$863.38	\$0.00
C. Building Completion Activity			
Equipment		\$150,000	\$0
Fixtures		\$0	\$0
Furnishings		\$0	\$0
Signage not in construction contract		\$5,000	\$0
Move-Out Cost/Temp. Reloc. Costs		\$0	\$0
Move-In Costs		\$20,000	\$0
Art		\$0	\$0
Other (List: _____)		\$0	\$0
OIT Support		\$35,000	\$0
Maintenance/Operation Support		\$75,000	\$1,170
<i>Building Completion Activity Subtotal</i>		\$285,000	\$1,170
D. Owner Activities & Administrative Cost			
Project Planning and Staff Support		\$271,268	\$13,014
Project Management		\$288,076	\$27,144
Misc Expenses: Advertising, Printing, Supplies		\$105,157	\$4,116
<i>Owner Activities & Administrative Cost Subtotal</i>		\$664,500	\$44,274
E. Total Project Cost		\$8,700,000	\$744,004
<i>Total Project Cost per GSF</i>		\$1,087.50	Remaining Budget
F. Total Appropriation(s)		\$8,700,000	\$7,955,996



Kuskokwim Campus Deferred Maintenance



Project Description:

Continued major deferred maintenance and code upgrades to over 50,000 square feet of space. Work will include upgrades to the electrical distribution system, correcting plumbing systems including providing two ADA compliant restrooms, installation of code compliant ventilation systems, and some finish work of interior surfaces.

Schedule:

Planning & Design:	November 2013—June 2014
Advertising & Award:	July—August 2014
Construction:	May 2015—August 2015

Total Project Cost:

TPC \$ 1,195,000
CAA \$ TBD

Project Team:

Design Team:	LSI
General Contractor:	TBD

Board of Regents Approval & Motions:

Preliminary Admin Approval:	FY12 Operating and Capital Budget Distribution
Schematic Design Approval:	April 16, 2014

Status Update:

Currently the design of this renovation of Sackett Hall has passed the 65% approval and is working toward a 95% design. Complete construction documents will be ready in mid-July.



Toolik Field Station Capital Improvements

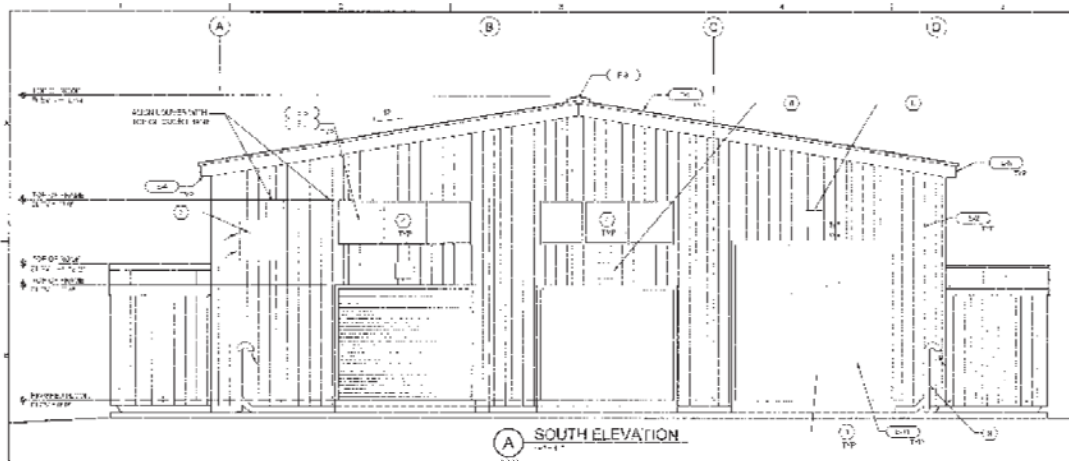

Project Description:

This is a NSF managed and funded project. Construction could start as early as May 2014. There are four projects currently planned as part of the capital improvement program. They are a combination of housing, science and support facilities that are needed to support the research at TFS. It is anticipated that funding will be phased and Schematic Design Approvals will be requested for each individual project as funding is identified. It is anticipated that funding will occur over a 2-4 year period for all of the projects.

Schedule:

Planning & Design:	March 2011 to August 2013
Advertising & Award:	January 2014 to April 2014
Construction:	May 2014 to November 2014

Total Project Cost:

TPC \$ 13,500,000

Project Team:

Design Team	CH2M Hill
General Contractor	TBD

Board of Regents Approval & Motions:

Formal Project /Schematic Design Approval September 27, 2012 (\$8,000,000)

Status Update:

Funding is available for the garage and lab. The bidding process started in March 2014 and concluded in May 2014. The bidding and project management is done by the National Science Foundation.



Auke Lake Way Corridor Improvements & Reconstruction



Project Description (Phase 4):

- New campus entry signage
- Reconstruction of pedestrian path and crossing
- Reconstructed bus stop at main entry

Total Project Cost: **\$4,500,000** **Phase 4 = \$485,800**

Project Engineer: R&M Engineering

Project Contractor: Arete Construction (Phase 3)

Project Schedule:	Phase 1	Phase 2	Phase 3	Phase 4
Planning & Design	1/2011 – 9/2011	8/2011-3/2012	10/2012 – 3/2013	11-2013-5/2014
Bid & Award	5/2011 – 6/2011	4/2012	4 & 5/2013	6/2014
Construction	4/2011 -10/2012	5/2012-1/2012	5/2013 –10/2013	7/2014-10-2014

Project Approvals

Formal Project Approval	December 2010
Schematic Approval (Phase 1)	April 2011
Schematic Approval (Phase 2)	April 2012
Schematic Approval (Phase 3)	March 2013
Schematic Approval (Phase 4)	May 2014

Status Update:

Schematic design for the phase 4 is completed with work expected for the summer of 2014.



New Freshman Residence Hall



Project Description

This project will construct a 35,000 gsf, 120 bed residential facility for freshman students.

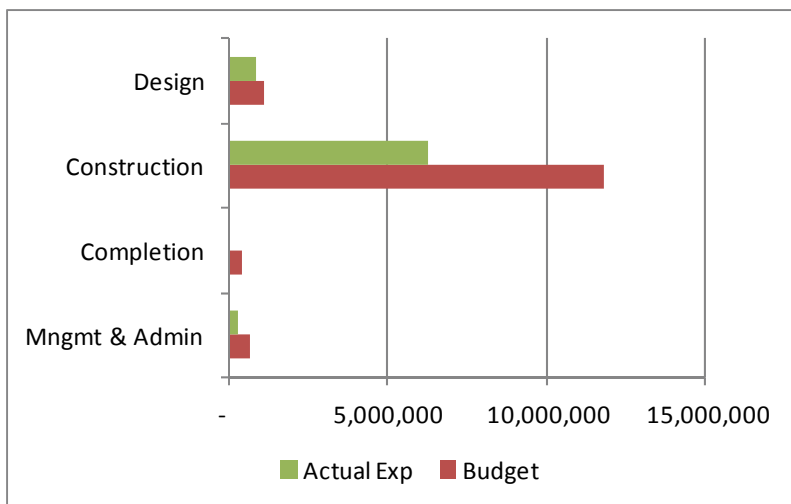

For actual values refer to attached budget sheet

BASIC PROJECT INFORMATION:

Designer: MRV Architects

Contractor: ASRC/McGraw

Board Approvals:

FPA 6/2011

SDA 9/2012

PCR 4/2013

Total Project Cost: 14,040,000

Construction Cost: 11,830,000

Occupancy Date: Fall 2014

Funding Source: GF/Debt

Schedule Bar

Design

Construction

Groundbreaking
June 2013

Chart:

90%
53%
Occupancy
August 2014

Status Update:

Finish work has begun throughout the building.



UAS Freshman Residence Hall

UNIVERSITY OF ALASKA

Project Name: New Freshman Residence Hall

MAU: UAS

Building: 30-Apr-13

Campus: Juneau

Prepared by: WK Gerken

Project #: 04-26

Acct #:

Total GSF Affected by Project: 34,768

PROJECT BUDGET
Total Project
**Total Expended
to Date**
A. Professional Services

Advance Planning, Program Development

Consultant: Design Services

715,000

715,000

Consultant: Construction Phase Services

310,000

65,545

Consul: Extra Services

0

0

Site Survey

0

0

Soils Testing & Engineering

42,966

42,966

Special Inspections

65,000

21,515

Plan Review Fees / Permits

0

Other

0

Professional Services Subtotal

1,132,966
845,026
B. Construction

Dorm Construction

award

7,419,998

6,143,337

alt#1

295,906

0

alt#3

40,000

0

alt#4

3,284,845

0

Utility Charges (AEL&P)

118,000

83,523

Wetlands mitigation

SEALTrust

12,018

12,018

Construction Contingency

6.0%

658,445

Construction Subtotal

11,829,212
6,238,878

Construction Cost per GSF

\$ 340.23

C. Building Completion Activity

Equipment

Fixtures

Furnishings

Move-Out Costs

Move-In Costs

Art

Other (Interim Space Needs or Temp Reloc. Costs)

OIT Support

Maintenance Operation Support

400,000

400,000

Building Completion Activity Subtotal

400,000

-

D. Owner Activities & Administrative Costs

Project Plng, Staff Support

0

Project Management

1.5%

200,252

147,525

CIP Indirect Support

3.5%

467,256

232,410

Owner Activities & Administrative Costs Subtotal

667,508
379,936
E. Total Project
14,029,686
7,463,840

Total Project Cost per GSF

\$ 403.52

Juneau Campus Modifications 2014-2016



Project Description: Renewal of the Whitehead and Hendrickson Buildings including replacement of heating, ventilation, lighting and electrical distribution systems. Building envelopes will be significantly improved to reduce energy consumption. Work will include relocations of current occupants and work outside of these two buildings that is required to accommodate occupant relocations.

Total Project Cost: \$12,771,000

Phase 1 - \$5,250,000

Project Architect: Northwind Architects

Project Contractor: TBD

Project Schedule: Phase 1

Planning & Design	2/2014 – 8/2014
Bid & Award	11/2014 – 12/2014
Construction	1/2015 - 10/2015

Project Approvals

Formal Project Approval

February 2014

Status Update:

Schematic design for Phase 1 is in progress.



June 2014 Board of Regents

Technical Education Center Renewal

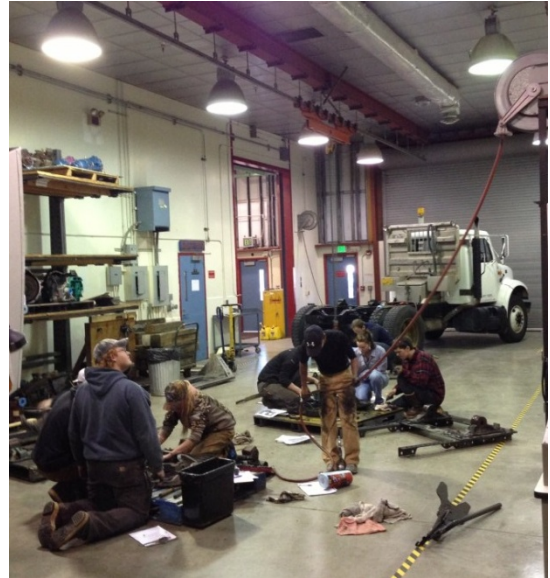

Project Description:

- Reconfigure program areas to reflect current demands, increase capacity of diesel education and mine training;
- Replacement or renewal of building mechanical, electrical systems to meet current codes, replace worn out equipment and reduce energy consumption and long term operating costs;

Total Project Cost: \$4,620,000

Phase 1 - \$1,500,000

Project Architect: JYL Architects

Project Contractor:

Project Schedule: Phase 1

Planning & Design	1/2013 – 4/2014
Bid & Award	4/2014 – 4/2014
Construction	5/2014 - 10/2014

Project Approvals

Formal Project Approval
Schematic Approval (Phase 1)

December 2013
May 2014

Status Update:

Schematic design for Phase 1 is completed, construction is expected for summer 2014.



June 2014 Board of Regents